

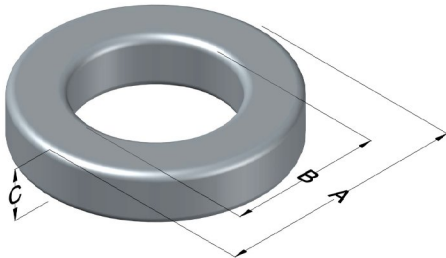

C055350A2

110 Delta Drive
 Pittsburgh, PA 15238
 NAFTA Sales: (1)800-245-3984
 HK Sales : (852)3102-9337
 magnetics@spang.com
 www.mag-inc.com



MPP Permeability (μ)	A_L (nH/T ²)	Core Marking			Coating Color
		Lot Number	Part Number	Inductance Grade	
125	105 \pm 8%	XXXXXX	55350A2	X	Gray

Dimensions	Uncoated		Coated Limits			Packaging
	(mm)	(in)	(mm)	(in)		
OD (A)	23.6	0.928	24.4	0.958	max	Cardboard cut-outs Box Qty= 480 pcs
ID (B)	14.4	0.567	13.7	0.542	min	
HT (C)	8.89	0.350	9.66	0.380	max	

Electrical Characteristics			Physical Characteristics						
Watt Loss @ 100 kHz, 100mT max(mW/cm ³)	DC Bias min (A-T/cm)		Voltage Breakdown wire to wire min (V _{AC})	Break Strength min (kg)	Window Area W _A (mm ²)	Cross Section A _e (mm ²)	Path Length L _e (mm)	Volume V _e (mm ³)	Weight (g)
	80%	50%							
950	19.8	38.5	1000	29	149	38.8	58.8	2,280	20

Winding Information				Temperature Rating	
Winding Length Per Turn				Wound Coil Dimensions (mm)	
Winding Factor	(mm)	Winding Factor	(mm)	Curie Temp: 460 °C	
				Coating Temp (Continuous up to): 200 °C	
				Notes:	
				Maximum OD (70%)	33.5
				Maximum HT (70%)	21.4
				Surface Area (mm ²)	
				Unwound Core	1,790
				40% Winding Factor	2,630

Typical DC Bias Performance

