

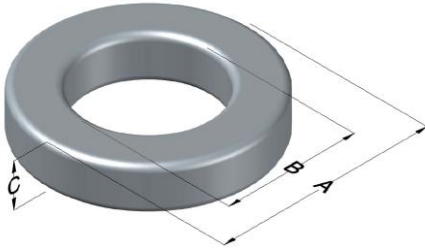

0079908A7

110 Delta Drive
 Pittsburgh, PA 15238
 NAFTA Sales: (1)800-245-3984
 HK Sales : (852)3102-9337
 magnetics@spang.com
 www.mag-inc.com



Kool M μ MAX Permeability (μ)	A _L (nH/T ²)	Core Marking			Coating Color
		Lot Number	Part Number	Inductance Grade	
26	37 \pm 8%	XXXXXX	79908A7	N/A	Black

Dimensions	Uncoated		Coated Limits			Packaging
	(mm)	(in)	(mm)	(in)		
OD (A)	77.80	3.063	78.95	3.108	max	Cardboard cut-outs Box Qty= 40 pcs
ID (B)	49.20	1.938	48.20	1.898	min	
HT (C)	15.9	0.625	17.1	0.670	max	

Electrical Characteristics			Physical Characteristics						
Watt Loss @100 kHz, 100mT max (mW/cm ³)	DC Bias min (A-T/cm)		Voltage Breakdown wire to wire min (V _{AC})	Break Strength min (kg)	Window Area W _A (mm ²)	Cross Section A _e (mm ²)	Path Length L _e (mm)	Volume V _e (mm ³)	Weight (g)
	800	80% 106							

Winding Information						Temperature Rating	
Winding Length Per Turn				Wound Coil Dimensions (mm)		Curie Temp: 500°C	
Winding Factor	(mm)	Winding Factor	(mm)	40% Winding Factor		OD	86.6
				HT	29.1		
0%	64.7	40%	89.9	Completely Full Window		Max OD	112
				Max HT	54.3		
20%	77.2	45%	93.1	Notes:			
25%	80.5	50%	96.8				
30%	82.7	60%	104	Surface Area (mm ²)		Coating Temp (Continuous up to): 200°C	
35%	86.8	70%	113	Unwound Core		11,000	
				40% Winding Factor		23,000	

