

**LEPCOS (North-West Laboratory)**

http://ferrite.ru Tel/fax +7-812-369-11-54

St-Petesburg, Russia

REVISIONS

REV	SYM	DRAFTER	CHECKER	DATE
△2		T.S.LII	W.H.HSU	08/23/05
△3		T.S.LII	W.H.HSU	07/24/06
△4		S.Y.TANG	G.F.YANG	11/13/07

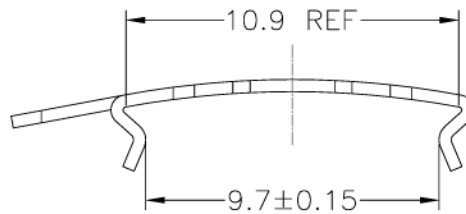
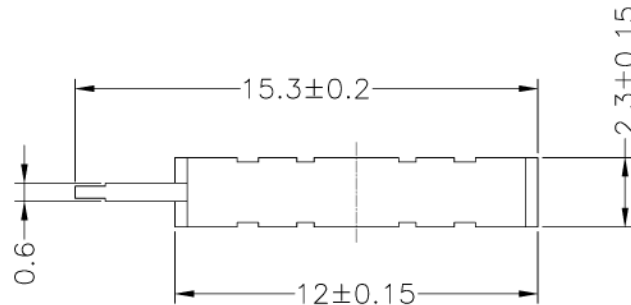
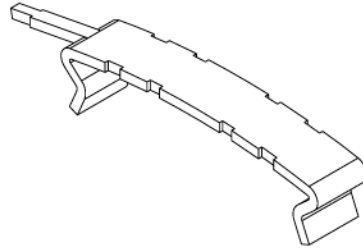

T = 0.4



DWG NO. RM6 clamp E-045C

PART NO.	MATERIAL (BOBBIN)	MATERIAL (CLIP)	TERMINAL (PLATING)	PIN ALLOCATION	NOTE
E-045C		SK7	Sn		

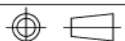

TOLERANCE: .X±0.15 .XX±0.10 .XXX±0.05

UNIT : m / m

SCALE 4 : 1

Finish: 1.Pb wire Immersion Sn on terminal : Thickness:Sn plating,100,5 μm (200 μ inches) min,Base nickel 0.625 μm (25 μ inches) min.  
 2.CP wire Immersion Sn on terminal : Thickness:Sn plating,100,5 μm (200 μ inches) min.  
 3. Coplanarity deviation: 0.10 mm (0.004 inches) max.

REV 4