

## Core **RM5**

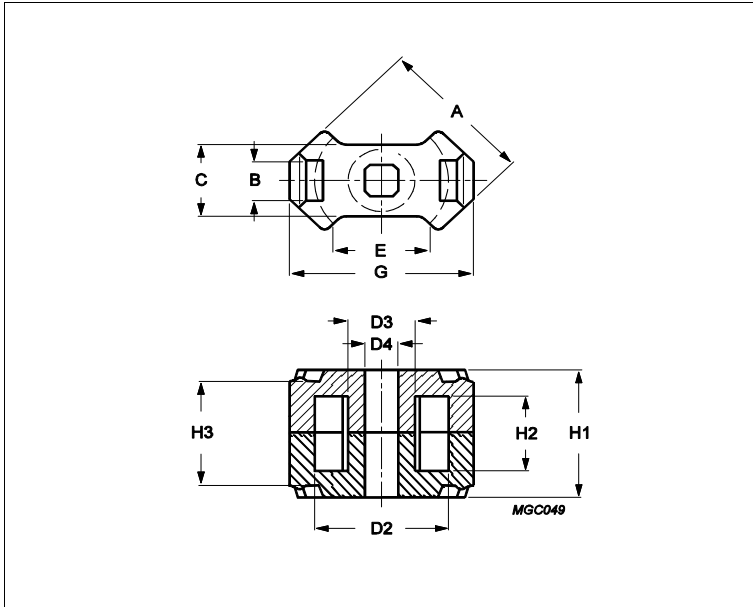

Effective parameters			
	Parameter	Value	Unit
$\Sigma(I/A)$	core factor (C1)	1.01	mm <sup>-1</sup>
<b>Ve</b>	effective volume	450	mm <sup>3</sup>
<b>Le</b>	effective length	21.4	mm
<b>Ae</b>	effective area	21.2	mm <sup>2</sup>
<b>Amin</b>	minimum area	14.8	mm <sup>2</sup>
<b>m</b>	RM5	≈ 3.1	g/set

Dimensions for product: RM5						
	Nom	Tol +	Tol -	Max	Min	Unit
<b>A</b>	12.30	0.00	0.50	12.30	11.80	mm
<b>B</b>	2.60			2.60	2.60	mm
<b>C</b>	6.80	0.00	0.40	6.80	6.40	mm
<b>D2</b>	10.20	0.40	0.00	10.60	10.20	mm
<b>D3</b>	4.90	0.00	2.00	4.90	2.90	mm
<b>D4</b>	2.04	0.06	0.00	2.10	2.04	mm
<b>E</b>					6.00	mm
<b>G</b>					14.90	mm
<b>H1</b>	10.40	0.10	0.10	10.50	10.30	mm
<b>H2</b>	6.30	0.40	0.00	6.70	6.30	mm
<b>H3</b>	9.10	0.20	0.20	9.30	8.90	mm

Inductance factor				
Material	Value	Tol +	Tol -	Unit
3D3	800	25%	25%	nH/turns <sup>2</sup>
3H3	1650	25%	25%	nH/turns <sup>2</sup>

Accessories		
Ordering name	Description	Ordering code
CLI/P-RM4/5	Clip, with ground pin	432202131904

## Core **RM5**

CPV-RM5-1S-8PD-Z	Coil former, termoplastic, vertical	432202106211
CSV-RM5-1S-4P-C	Coil former, termoset, vertical	432202107461
CSV-RM5-1S-4P-IZ	Coil former, termoset, vertical	432202106871
CSV-RM5-1S-6P-G	Coil former, termoset, vertical	432202100851
CSV-RM5-1S-6P-TZ	Coil former, termoset, vertical	432202106231
CSV-RM5-2S-4P-IZ	Coil former, termoset, vertical	432202106881
CSV-RM5-2S-6P	Coil former, termoset, vertical	432202134501
CSV-S-RM5-1S-8P	Coil former, termoset, vertical, SMD	432202102881
CSV-S-RM5-1S-8P-Z	Coil former, termoset, vertical, SMD	432202106361