



Product information

IEC Socket type power filter-DB15

Description

Small size, easy to install, customizable, with strong anti-interference, high performance characteristics, AC power socket input, 6.3x0.8 chip output connection, IEC socket, dual fuse and switch three-in-one modular design.

Technical Data

Rated Voltage	115/250VAC
Line Frequency	50/60Hz
Test Voltage	1500VDC (line/line) 2150VAC (line/ground)
Insulation Resistance	>50M @500VDC
Temperature Rise	<30
Climatic Category	25/085/21
Housing Material	Nickel-plated iron

Approval & Compliance



Features

- Rated current : 1A-10A
- Strong anti-interference, high performance
- Chip output with dual fuses and switches.
- Can be customized upon request

Applications

- Portable electrical and electronic equipment
- Single-phase power supply, switching power supply
- Test and measurement equipment
- EDP and office equipment
- Medical equipment, etc.

Performance Indicator

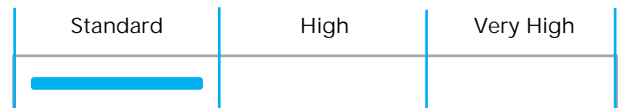

Rated Current [A]

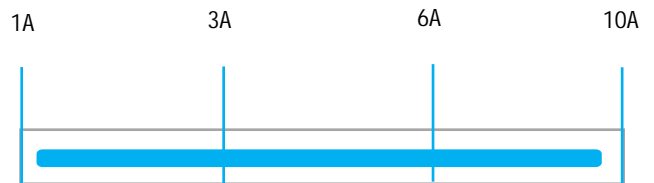

Typical Circuit Diagram

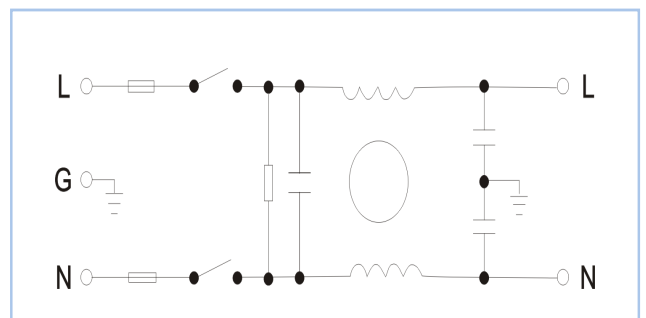

Part No	Rated Current	Rated Current	Case Type	Termination		Safety Certification	Remark
				Input	Output		
DBI5-1A-S	1A	<0.5mA	I5	Socket	Terminal	cUL, CE, ROHS	Parameter customization
DBI5-3A-S	3A	<0.5mA	I5	Socket	Terminal		
DBI5-6A-S	6A	<0.5mA	I5	Socket	Terminal		
DBI5-10A-S	10A	<0.5mA	I5	Socket	Terminal		

Overall Dimension (±1mm)

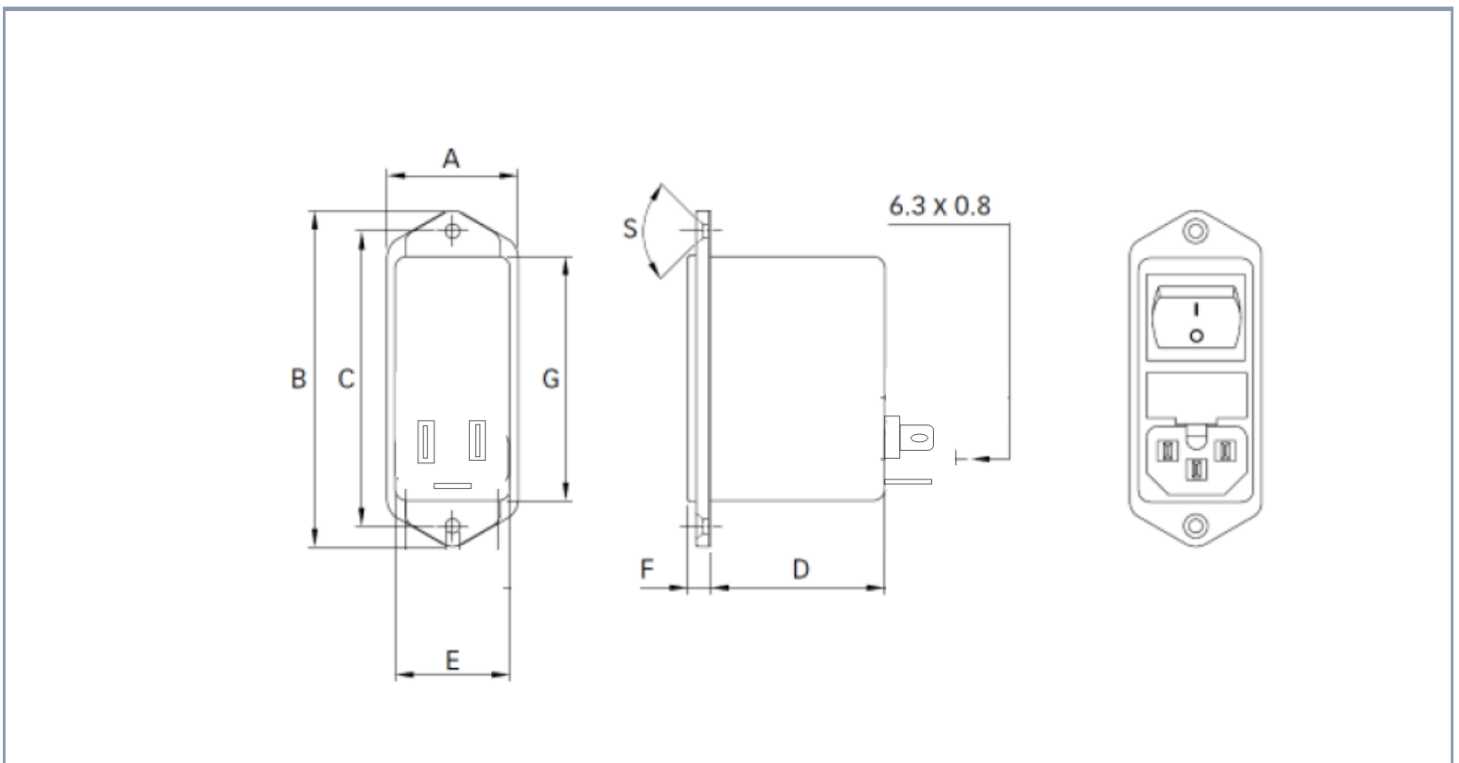

Insertion loss -(common mode)

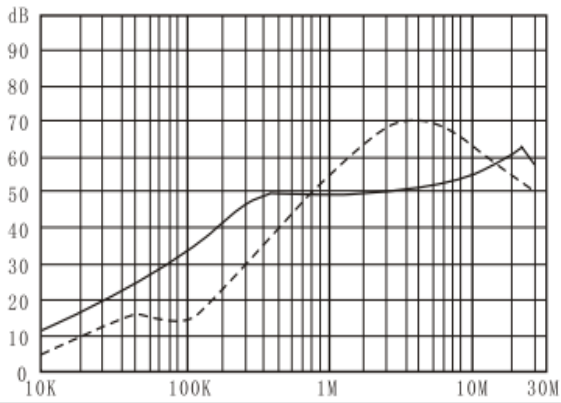

DBI5-1A

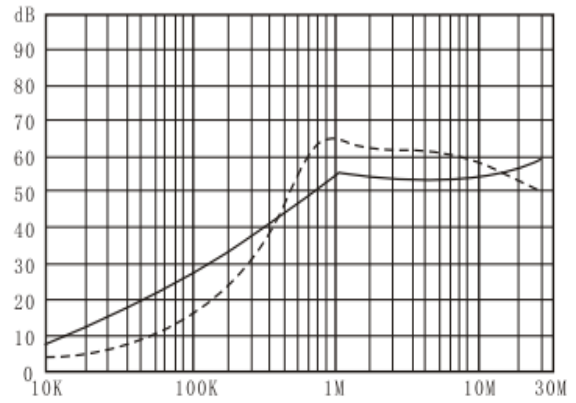

DBI5-3A

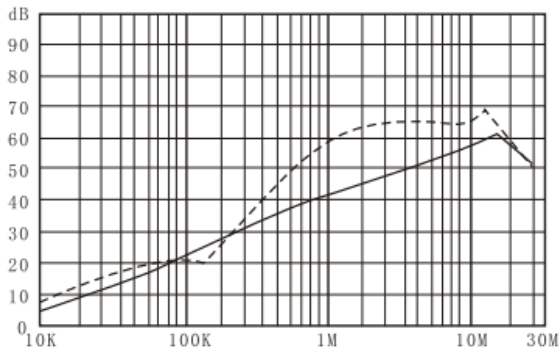

DBI5-6A

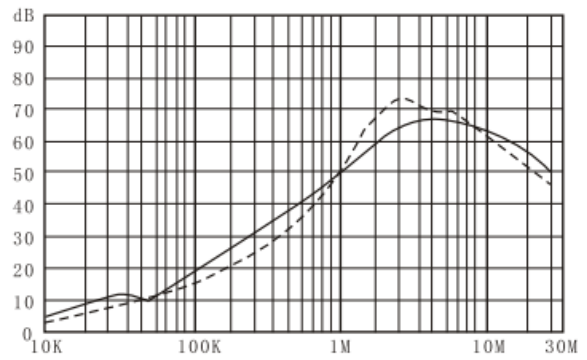

DBI5-10A