

# Split EMI Suppression Cores (CF Series)

## Description :

Split EMI Suppression Core (CF Series) consists with a nylon plastic case and two half ferrite cores. It can be installed to cable easily so don't need cut the existing cable firstly and can be removed from cable without damage. Due to this feature, it can be installed after assembly products to save the time before marketing. If the design need higher impedance, increase the wire turns through the core is a fast and easy solution.

**RoHS 2.0**  
2011/65/EU

## Applications :

- Suppress high frequency noise from cables to compliance with FCC, VDE and VCCI.
- Suitable for various power / signal cables inside or outside the equipments.
- Widespread use for electric equipments like NB, PC, monitor, printer, digital camera, power supply, DVD player, fax machine, medical equipment, internet wire, and etc.

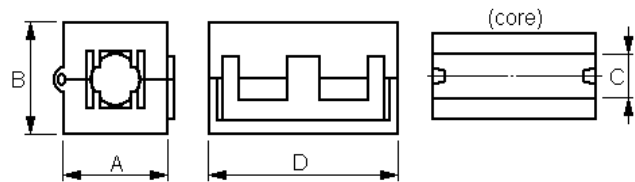

Part Number	A (mm)	B (mm)	C (mm)	D (mm)	Typical Impedance (ohm)			Z-F Fig.
					25MHz	100MHz	200MHz	
CF-65SN	17.8	19.5	6.5	32.5	140	270	325	1
CF-65SH					95	265	445	
CF-100SN	22.3	23.3	10.0	32.6	130	225	265	2
CF-100SH					80	235	400	
CF-130SN	29.6	30.5	13.0	33.0	125	280	310	3
CF-130SH					90	255	390	

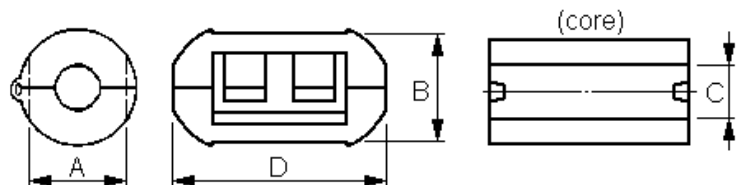

Part Number	A (mm)	B (mm)	C (mm)	D (mm)	Typical Impedance (ohm)			Z-F Fig.
					25MHz	100MHz	200MHz	
CF-50R	14.5	15.7	5.6	29.0	75	155	230	5
CF-75RH	18.9	20.7	7.0	39.1	105	285	385	6

# Split EMI Suppression Cores (CF Series)

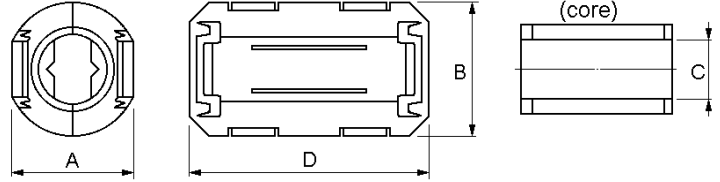

Part Number	A (mm)	B (mm)	C (mm)	D (mm)	Typical Impedance (ohm)			Z-F Fig.
					25MHz	100MHz	200MHz	
CF-35MN	11.7	13.0	3.5	25.0	120	165	200	4
CF-50MN	11.7	13.0	5.0	25.0	75	165	255	5
CF-70M	14.8	17.0	7.0	30.0	80	155	215	6
CF-90MN	18.0	19.7	9.0	35.0	90	205	290	7

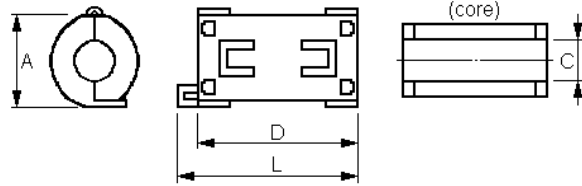

Part Number	A (mm)	C (mm)	D (mm)	L (mm)	Typical Impedance (ohm)			Z-F Fig.
					25MHz	100MHz	200MHz	
CF-110A	20.1	11.1	32.0	36.1	65	105	160	8
CF-130AN	29.5	13.0	34.0	39.2	100	205	265	3

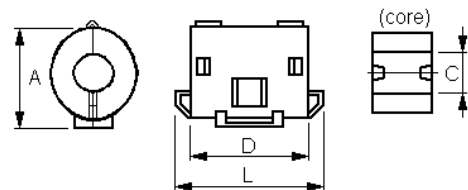

Part Number	A (mm)	C (mm)	D (mm)	L (mm)	Typical Impedance (ohm)			Z-F Fig.
					25MHz	100MHz	200MHz	
CF-80U1	21.5	8.15	16.8	23.0	40	95	160	9
CF-80U2	21.5	8.15	19.7	25.8	50	105	170	9
CF-115U	30.5	11.4	17.7	24.0	35	80	155	7
CF-150U	31.5	15.0	15.2	21.5	40	90	165	8

# Split EMI Suppression Cores (CF Series)

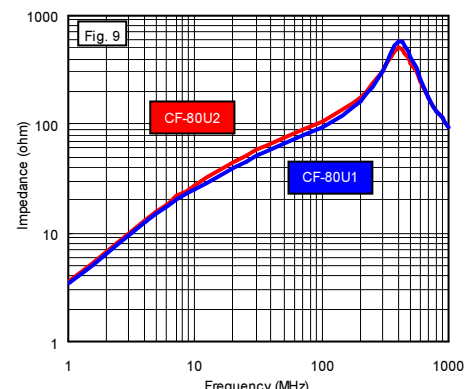
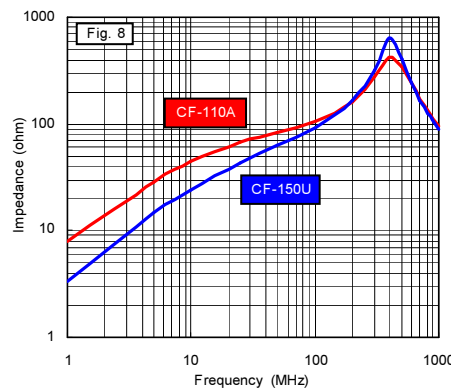
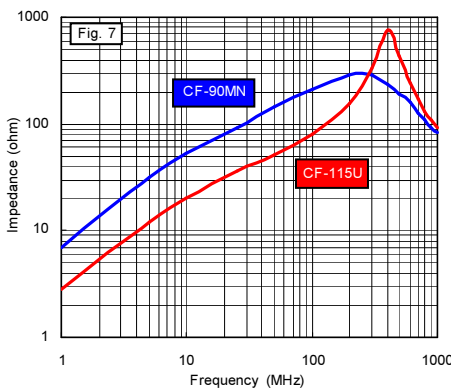
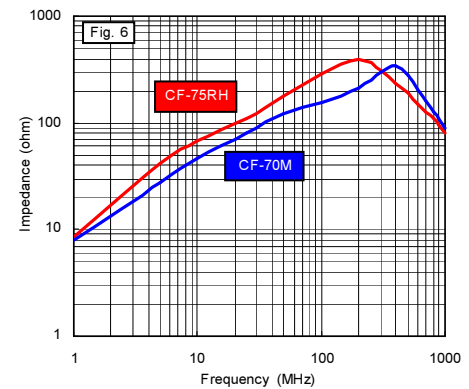
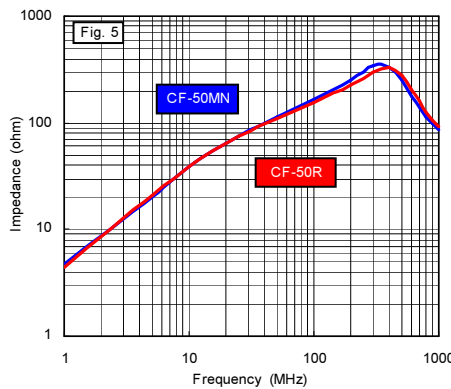
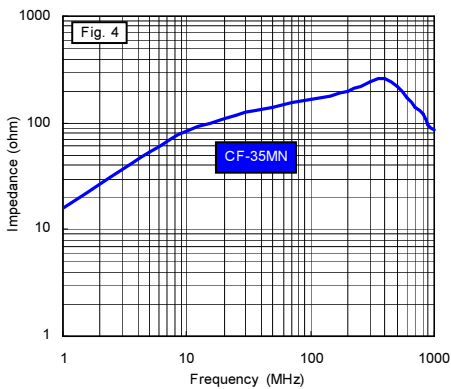
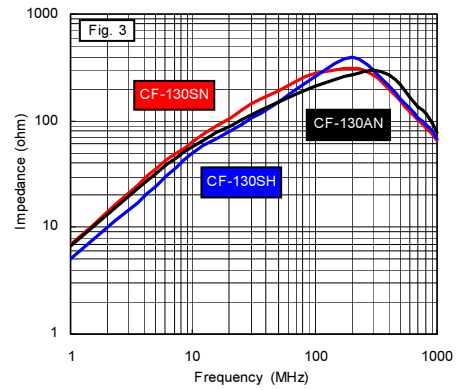
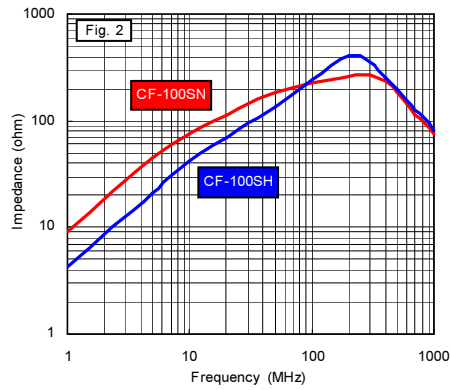
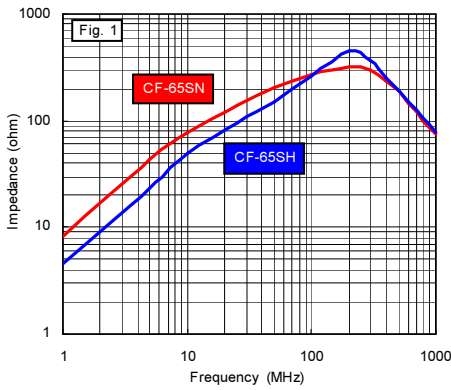

Note : 1. Above test condition is a diameter 1.0mm with 10cm length wire through the core to compare the impedance for reference.  
2. For actually application, the wire length and diameter is different and impedance reading will not the same.

