

### H cores

#### CORE SETS

##### Effective core parameters

SYMBOL	PARAMETER	VALUE	UNIT
$\Sigma (1/A)$	core factor ( $C_1$ )	2.73	$\text{mm}^{-1}$
$V_e$	effective volume	690.06	$\text{mm}^3$
$l_e$	effective length	43.40	mm
$A_e$	effective area	15.90	$\text{mm}^2$
$W_t$	mass of core	$\approx 3.5$	g

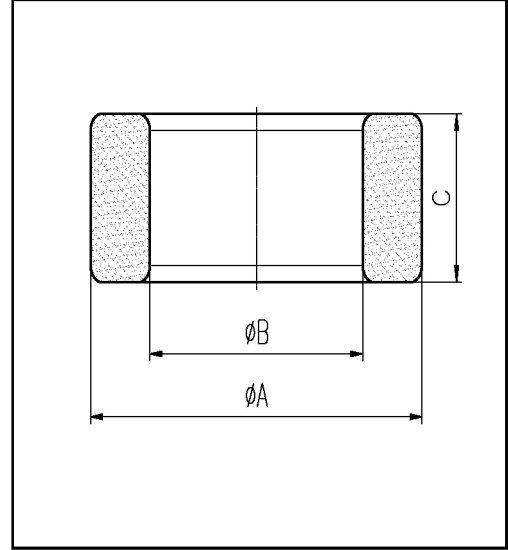

尺寸	A	B	C
Coat			
Uncoat	$16.0 \pm 0.4$	$12.0 \pm 0.3$	$8.0 \pm 0.3$
Coated	$16.8_{\text{max}}$	$11.3_{\text{min}}$	$8.7_{\text{max}}$

Note: With grass green epoxy coating

#### Characteristic

GRADE	AL ( $\text{nH}/\text{N}^2$ )	B (mT)	CORE LOSS (W)
		$f=10\text{kHz}$ $U=0.25\text{V}$	$H=250\text{A/m}$ $f=25\text{kHz}$ $T=100^\circ\text{C}$
DMR40	$1050 \pm 25\%$	$\geq 315$	$\leq 0.10$
DMR44	$1150 \pm 25\%$	$\geq 315$	$\leq 0.09$