

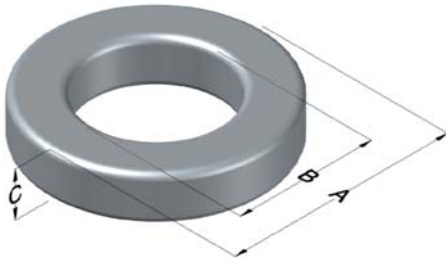

0088083A7

110 Delta Drive
 Pittsburgh, PA 15238
 NAFTA Sales: (1)800-245-3984
 HK Sales : (852)3102-9337
 magnetics@spang.com
 www.mag-inc.com



AmoFlux Permeability (μ)	A_L (nH/T ²)	Core Marking			Coating Color
		Lot Number	Part Number	Inductance Grade	
60	81 \pm 8%	XXXXXX	88083A7	N/A	Blue

Dimensions	Uncoated		Coated Limits			Packaging
	(mm)	(in)	(mm)	(in)		
OD (A)	39.90	1.570	40.77	1.605	max	Cardboard cut-outs Box Qty= 180 pcs
ID (B)	24.1	0.950	23.3	0.918	min	
HT (C)	14.5	0.570	15.4	0.605	max	

Electrical Characteristics			Physical Characteristics						
Watt Loss @ 100 kHz, 100mT max(mW/cm ³)	DC Bias min (A-T/cm)		Voltage Breakdown wire to wire min (V _{AC})	Break Strength min (kg)	Window Area W _A (mm ²)	Cross Section A _e (mm ²)	Path Length L _e (mm)	Volume V _e (mm ³)	Weight (g)
1000	80%	50%	2000	79	427	107	98.4	10,600	60
	47.7	95.4							

Winding Information					Temperature Rating	
Winding Length Per Turn				Wound Coil Dimensions (mm)		Curie Temp: 500°C
Winding Factor	(mm)	Winding Factor	(mm)	Maximum OD (70%)	56.4	Coating Temp (Continuous up to): 155°C
0%	48.2	40%	60.2	Maximum HT (70%)	35.2	Notes:
20%	54.3	45%	62.1	Surface Area (mm ²)		
25%	55.8	50%	63.7	Unwound Core		
30%	57.0	60%	67.3	40% Winding Factor		
35%	58.8	70%	71.5			