

CORE SETS

Effective core parameters

SYMBOL	PARAMETER	VALUE	UNIT
$\Sigma (1/A)$	core factor (C_1)	2.45	mm^{-1}
V_e	effective volume	359.37	mm^3
l_e	effective length	29.70	mm
A_e	effective area	12.40	mm^2
A_{min}	minimum area	12.10	mm^2
W_t	mass of core set	≈ 1.8	g

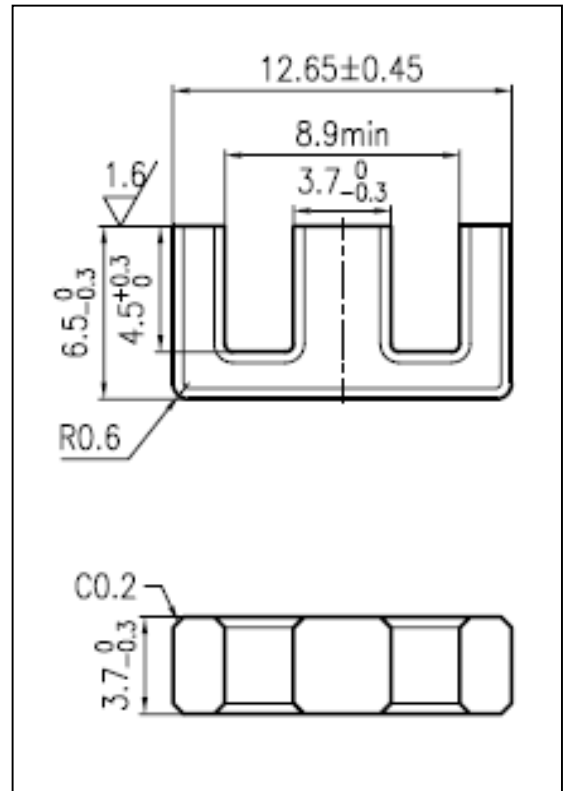

Characteristic

GRADE	AL (nH/N^2)	B (mT)	CORE LOSS (W)
	$f=10\text{kHz}$ $U=0.25\text{V}$	$H=250\text{A}/\text{m}$ $f=25\text{kHz}$ $T=100^\circ\text{C}$	$f=100\text{kHz}$ $B=200\text{mT}$ $T=100^\circ\text{C}$
DMR40	$750 \pm 25\%$	—	≤ 0.26
DMR44	$750 \pm 25\%$	—	≤ 0.22